

(April 2014)

# RMS “Flip-Up” Style ANTI-TIP DEVICES

## FITTING INSTRUCTIONS (Covering Part Numbers L1-P02-F3##)

### IMPORTANT NOTE:

RMS Anti-Tip devices are handed and **MUST** be fitted in pairs. It is recommended that these devices be installed by a suitably qualified person.

### PRE-FITTING

- Fully open wheelchair, stand on level surface and apply Parking Brakes.
- Inflate pneumatic tyres to the correct manufacturers recommended pressures.

### FITTING

- Remove any original equipment tipping lever plastic/rubber sleeves.
- With Anti-Tip stems (a) pointing forwards, see Fig.1, and the locking buttons (b) pointing towards the centre of the wheelchair, install devices over each tipping lever until there is approximately 15mm \* (5/8”) of tipping lever exposed through the Hayden Clamp.



### IMPORTANT NOTE:

\* This figure should be used as a guide only, as care must be taken to ensure that the Anti-Tip lever brackets (c) Fig. 1 are always mounted forward of the tyre treads, to avoid contact with steps, kerbs or thresholds.

- Depress locking buttons and lower Anti-Tip lever stems until locking buttons engage into the lower rear holes, see Fig.2.
- With the stems in a vertical position, a ground clearance of approximately 13mm (1/2”) should exist. (This may vary slightly between wheelchair models). \*\*
- Tighten Hayden Clamp bolts to 22Nm (16 ft/lbs).
- When Anti-Tips are not required, depress locking buttons and swing stems forward until locking buttons engage in the upper forward holes.

### WARNING

\*\* If, for any reason, the rear wheels or tyres of the wheelchair are changed from the original equipment specification, the position of the Anti-Tip devices may need to be altered accordingly.

All fixings should be checked for security on a regular basis.

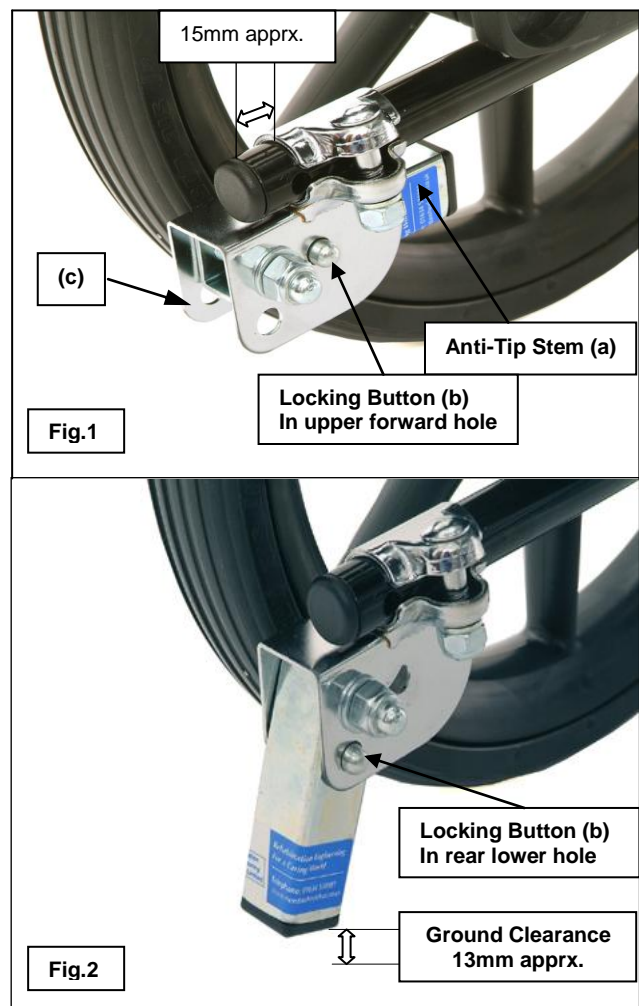

# RMS “Flip-Up” Style ANTI-TIP DEVICES

## USER / CARER INSTRUCTIONS

### IMPORTANT NOTE:

Flip-Up style Anti-Tip devices when fitted to a wheelchair, offer improved rearward stability. They should always be set to the operational position (as picture) if the wheelchair and occupant are to be left unattended.

### OPERATING FLIP-UP STYLE ANTI-TIP LEVERS

#### TO BRING INTO OPERATIONAL POSITION

- Depress locking button (a) located on the inner face of the Anti-tip Bracket.
- Lower Anti-tip Lever Stem until the locking button locates into lower hole (b).
- Check Anti-tip Lever Stem cannot be pushed forward.

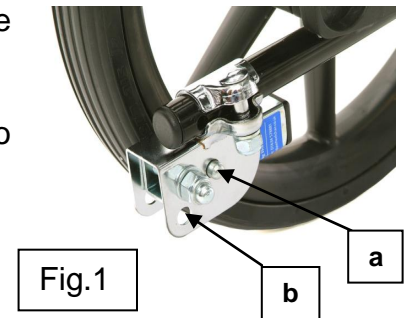

#### TO RETURN ANTI-TIP LEVERS TO RAISED POSITION

- Depress locking button (a)
- Push Anti-tip Lever Stem forwards until locking button locates into upper hole (c).

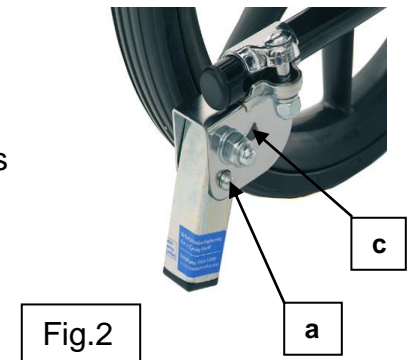

### WARNINGS

- **Wherever possible, the Anti-Tip devices should be set to the raised position when the wheelchair is being manoeuvred.**
- **Security of the Ant-Tip devices should be checked on a regular basis.**
- **Pneumatic tyres should be kept inflated to their recommended pressures.**