

GILL 3 Modular Adjustable Seating System



Wheelchair Service
 Contact Name
 Client Name
 Delivery Address

Date
 Title
 Ref No.....

Tel. No Fax No

Email

Standard Gill 3 comprises of:-

- Seat board c/w Lock & Latch interface
- Backrest c/w Lock & Latch interface
- Fixed pelvic supports
- Headrest
- 15° ramped seat cushion
- Velcro attached flat backrest cushion
- Swing away flat thoracic support
- Pelvic belt (padded)

For standard Gill 3, complete boxes 1-8; alternatively all parts can be supplied separately

1. SIZE GUIDE		STANDARD SIZES LISTED BELOW - ONE BOX MUST BE TICKED							
Gill 3 model	A <input type="checkbox"/>	B <input type="checkbox"/>	C <input type="checkbox"/>	D <input type="checkbox"/>	E <input type="checkbox"/>	F <input type="checkbox"/>	G <input type="checkbox"/>	H <input type="checkbox"/>	I <input type="checkbox"/>
Wheelchair size	305 (12")	330 (13")	355 (14")	380 (15")	405 (16")	430 (17")	455 (18")	480 (19")	510 (20")
Seat width min	180	190	215	240	265	290	315	340	365
Seat width max	280	290	315	340	365	390	415	440	465
Seat depth min	220	245	245	325	325	350	375	375	375
Seat depth max	345	360	360	440	440	465	490	490	490
Backrest height	360	410	410	460	460	510	510	560	560

Please note: the above dimensions are in conjunction with 8 & 9 series wheelchairs. These may vary due to other wheelchair manufacturers tolerances.
 All dimensions are in mm unless otherwise stated

2. Client Measurements	
A	Pelvic width
B	Seat depth
C	Footrest height
D	Shoulder height
E	Thoracic pad height
F	Thoracic pad width
G	Ramp length
H	Knee centres
I	Sacral pad height (std with kneeblock)

Measurement Chart

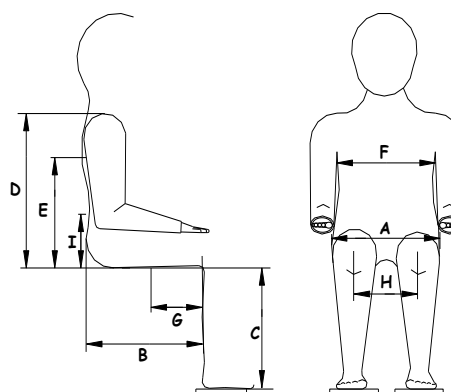

3. Wheelchair information	
Manufacturer:	
Model:	
Size:	

4. Pelvic pads (pair) (HxD) Two boxes must be ticked			
Fixed	<input type="checkbox"/>	Swing away	<input type="checkbox"/>
75mmx150mm	<input type="checkbox"/>	100mmx150mm	<input type="checkbox"/>
100mmx200mm	<input type="checkbox"/>	100mmx250mm	<input type="checkbox"/>
Customised Pelvic Pads <input type="checkbox"/> H = mm x D = mm			

5. Seat	
15° ramped cushion	<input type="checkbox"/>
10° ramped cushion	<input type="checkbox"/>
Flat cushion (50mm thick)	<input type="checkbox"/>
Seat board only	<input type="checkbox"/>

7. Backrest	
Std backrest with Velcro attached cushion + Lock & Latch interface	<input type="checkbox"/>
Backrest cushion style:	flat <input type="checkbox"/>
Backrest cushion style:	curved <input type="checkbox"/>

8. Upholstery	
Black spacer fabric with edging in Black	<input type="checkbox"/>
Black spacer fabric with edging in Royal Blue	<input type="checkbox"/>
Black spacer fabric with edging in Red	<input type="checkbox"/>
Black spacer fabric with edging in Midnight Blue	<input type="checkbox"/>
Black spacer fabric with edging in Purple	<input type="checkbox"/>

6. Thoracic pads (pair) (HxD) Three boxes must be ticked			
Fixed	<input type="checkbox"/>	Swing away	<input type="checkbox"/>
Flat	<input type="checkbox"/>	Curved	<input type="checkbox"/>
75mmx125mm	<input type="checkbox"/>	75mmx150mm	<input type="checkbox"/>
100mmx150mm	<input type="checkbox"/>		
Customised Thoracic Pads <input type="checkbox"/> H = mm x D = mm			

- Standard option
- No cost option
- Upcharge option

8. Kneeblock - four boxes must be ticked	<input type="checkbox"/>	<input type="checkbox"/>	<input type="checkbox"/>	<input type="checkbox"/>
Pommel - three boxes must be ticked	<input type="checkbox"/>	<input type="checkbox"/>	<input type="checkbox"/>	<input type="checkbox"/>
Std. Mounting type: Pop pin				
Pad Height	75mm	<input type="checkbox"/>	100mm	<input type="checkbox"/>
A	90mm	<input type="checkbox"/>	110mm	<input type="checkbox"/>
B	60mm	<input type="checkbox"/>	75mm	<input type="checkbox"/>
		<input type="checkbox"/>	100mm	<input type="checkbox"/>

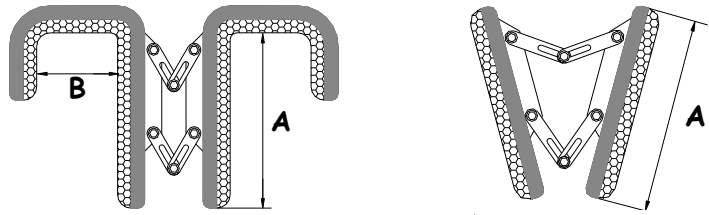

9. Contoured Tray - one box must be ticked			
Small	<input type="checkbox"/>	Standard Drop in Brackets	<input type="checkbox"/>
A=510mm B=510mm		Swing over tray brackets	<input type="checkbox"/>
C=330mm D=150mm		Ply/formica	<input type="checkbox"/>
Medium	<input type="checkbox"/>	Clear Lexan	<input type="checkbox"/>
A=560mm B=560mm		Comfort Pad=30% of A	<input type="checkbox"/>
C=360mm D=200mm		Fully Padded Top	<input type="checkbox"/>
Large	<input type="checkbox"/>	Tray Receiver Sockets	<input type="checkbox"/>
A=610mm B=610mm		Edging	<input type="checkbox"/>
C=430mm D=225mm			

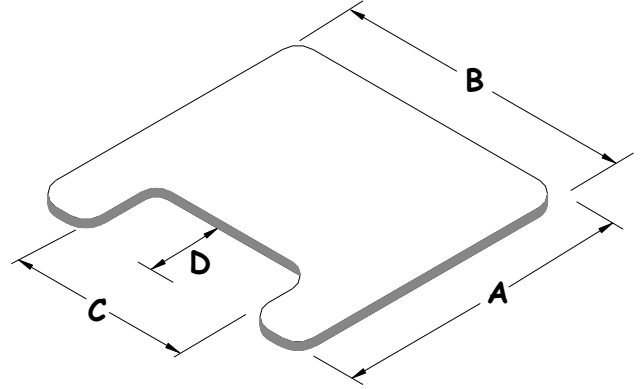

10. Accessories	Specify part number from RMS Accessories Catalogue or Website: www.inedawheelchair.co.uk
Headrest	
Pelvic belt	
Harness	
Foot control	

11. Additional Information

Estimate to be raised from prescription

